

## Underbench units

### Underbench unit on plinth

#### Intended use

- For storing equipment and chemicals in acc. with EN 14727
- For working heights of 750 mm and 900 mm
- Not suitable for storing flammable liquids, gas cylinders and self-igniting or self-decomposing substances
- Not suitable for storing acids and alkalis

#### Design

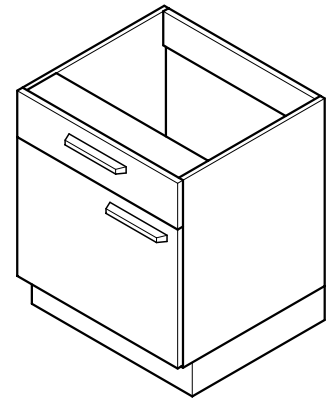

#### Variants

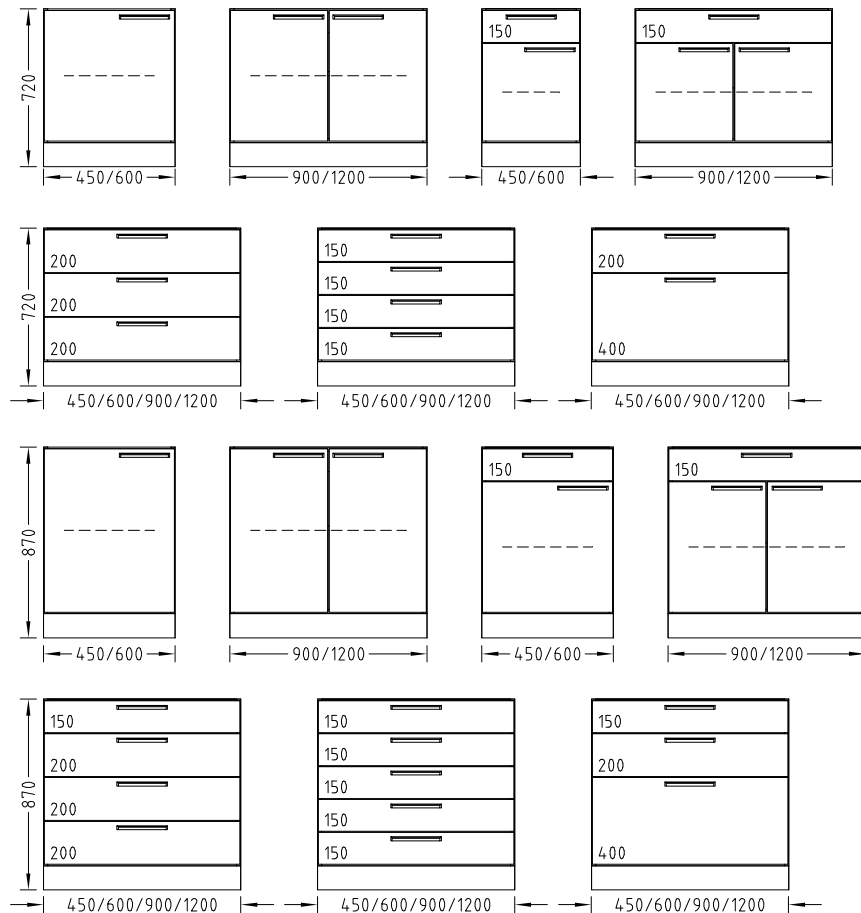

# Underbench units

## Underbench unit on plinth

### Technical data

Dimensions				
Width [mm]	450	600	900	1200
Depth [mm]	550			
Overall height [mm]	720 870			
Height, drawers [mm]	150 200 400 Combination possibilities see variants			
Height, plinth [mm]	110			

Load bearing capacity	
Per shelf/drawer [kg]	30

Design characteristics	
Construction	For working height 750 and 900 mm Hinged doors with 270° hinges Drawers, fully extensible Open at the top, rear panel can be removed Shelf, height-adjustable Without doors as a rack 4 height-adjustable feet
Combination possibilities	See variants
Handle	Handle bar <i>SCALA</i> U handle, stainless steel
Drawers with change-pull-out catch	Optional
Full-height drawers	Optional
Soft stop for drawer	Optional
Extract air spigot	Optional
Closing	Optional

## Underbench units

### Underbench unit on castors

#### Intended use

- For storing equipment and chemicals flexibly in acc. with EN 14727
- For working heights of 750 mm and 900 mm
- Not suitable for storing flammable liquids, gas cylinders and self-igniting or self-decomposing substances
- Not suitable for storing acids and alkalis

#### Design

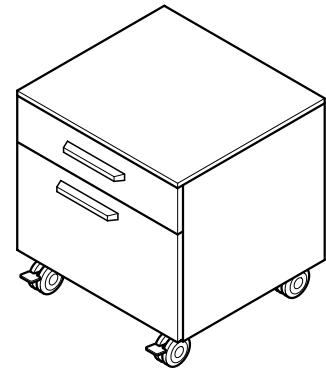

#### Variants

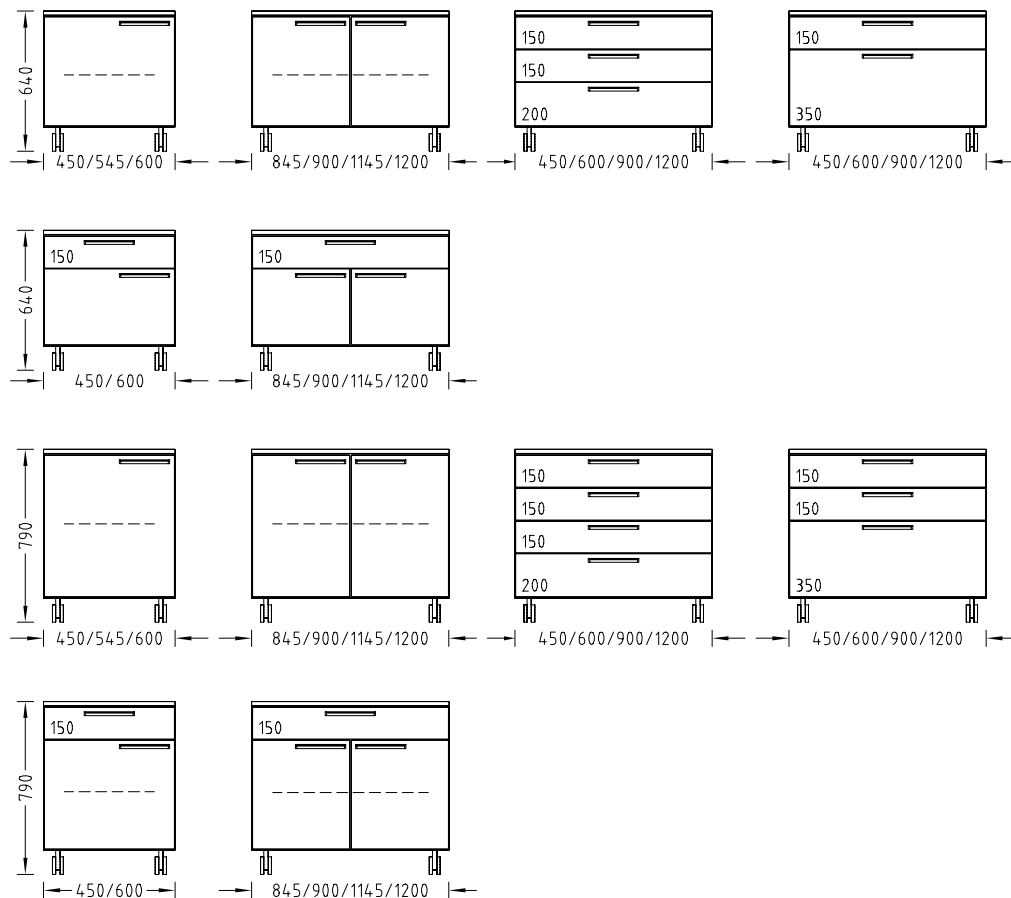

## Underbench units

### Underbench unit on castors

#### Technical data

Dimensions							
Width [mm]	450	545	600	845	900	1145	1200
Depth [mm]	550						
Overall height [mm]	640 790						
Height, drawers [mm]	150 200 350 Combination possibilities see variants						
Height, castors [mm]	110						

Load bearing capacity	
Per shelf/drawer [kg]	30
Per castor [kg]	70

Design characteristics	
Construction	For working height 750 and 900 mm Hinged doors with 270° hinges Drawers, fully extensible and with change-pull-out catch Shelf, height-adjustable Without doors as a rack Covered at the top, rear panel permanently connected with the carcass 4 swivelling castors, front castors can be locked
Combination possibilities	See variants
Handle	Handle bar SCALA U handle, stainless steel
Soft stop for drawer	Optional
Closing	Optional

## Underbench units

### Suspended underbench unit

#### Intended use

- For storing equipment and chemicals flexibly in acc. with EN 14727
- For working heights of 750 mm and 900 mm
- Not suitable for storing flammable liquids, gas cylinders and self-igniting or self-decomposing substances
- Not suitable for storing acids and alkalis

#### Design

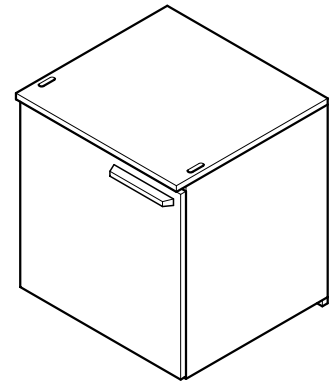

#### Variants

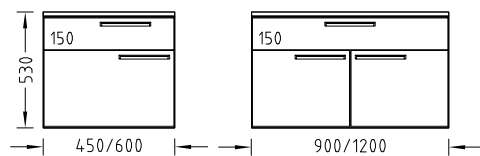
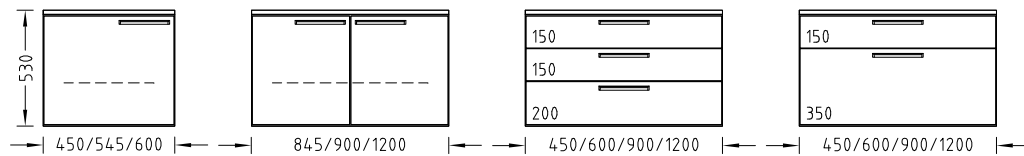
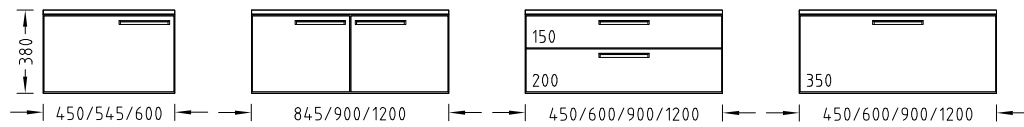

# Underbench units

## Suspended underbench unit

### Technical data

Dimensions							
Width [mm]	450	545	600	845	900	1145	1200
Depth [mm]	500 (depth of frame 572) 550 (depth of frame 672)						
Height [mm]	380 530						
Height, drawers [mm]	150 200 350 Combination possibilities see variants						

Load bearing capacity	
Per shelf/drawer [kg]	30

Design characteristics	
Construction	For working height 750 and 900 mm 2 fittings for attaching to the profile rail of the bench frame Hinged doors with 270° hinges Drawers, fully extensible Covered at the top, rear panel permanently connected with the carcass Shelf, height-adjustable For C-frame/cantilever bench frame: Can be moved to the sides until it protrudes over the bench grid Hinged doors with 1 shelf at a height of 530 mm At a height of 530 mm without doors as a rack with 1 shelf
Combination possibilities	See variants
Handle	Handle bar <i>SCALA</i> U handle, stainless steel
Drawers with change-pull-out catch	Optional
Soft stop for drawer	Optional
Closing	Optional

## Underbench units

### Self-supporting underbench unit for fume cupboards

#### Intended use

- For storing equipment and chemicals in acc. with EN 14727
- For fume cupboards with rear panel installation and for fume cupboards with side installation
- Not suitable for storing flammable liquids, gas cylinders and self-igniting or self-decomposing substances
- Not suitable for storing acids and alkalis

#### Design

For fume cupboards with rear panel installation

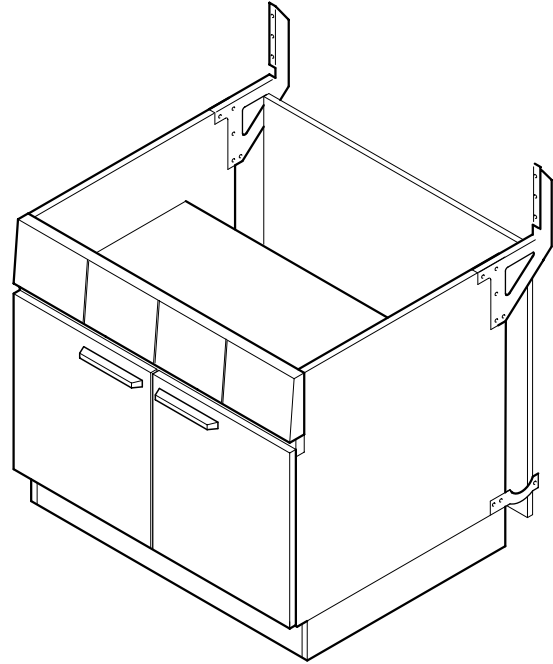

For fume cupboards with side installation

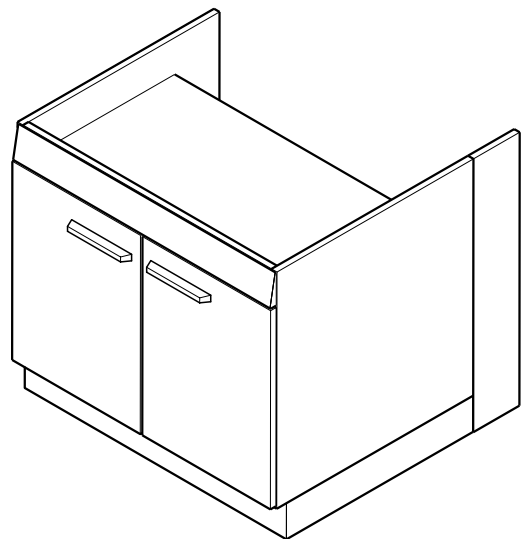

# Underbench units

## Self-supporting underbench unit for fume cupboards

### Variants

#### For fume cupboards with rear panel installation



#### For fume cupboards with side installation

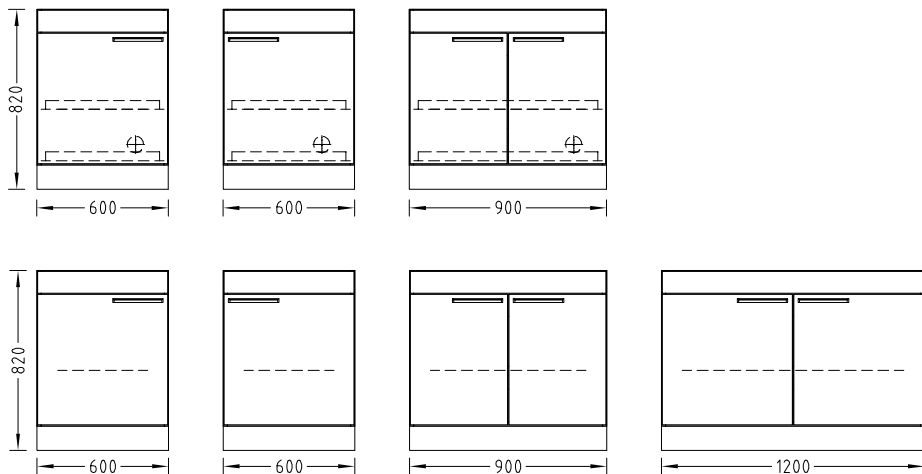

## Underbench units

### Self-supporting underbench unit for fume cupboards

#### Technical data

Dimensions			
Width [mm]	600	900	1200
Depth [mm]	550		
Overall height [mm]	820		
Height, plinth [mm]	110		

Load bearing capacity	
Per shelf [kg]	30

Design characteristics	
Construction	Hinged doors with 270° hinges Service panel above the storage cupboard for fume cupboards with rear panel installation Closed at the top, rear panel can be removed Shelf, height-adjustable 4 height-adjustable feet
Combination possibilities	See variants
Full-height drawers	Optional
Extract air spigot	Optional
Underbench exhaust	Optional
Acid and alkali equipment	Optional
Closing	Optional
Handle	Handle bar <i>SCALA</i> U handle, stainless steel

# Underbench units

## Push-in underbench unit for fume cupboards

### Intended use

- For storing equipment and chemicals in acc. with EN 14727
- For fume cupboards with rear panel installation and for fume cupboards with side installation on a steel support frame
- Not permitted for storing flammable liquids, gas cylinders and self-igniting or self-decomposing substances
- Not permitted for storing acids and alkalis

### Design

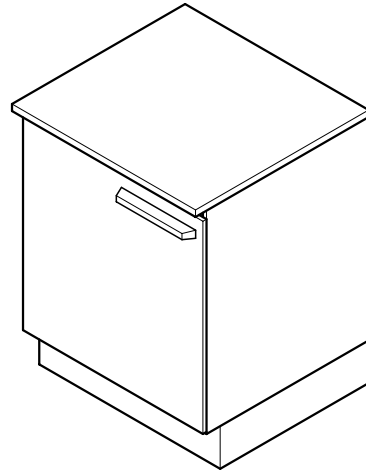

### Variants

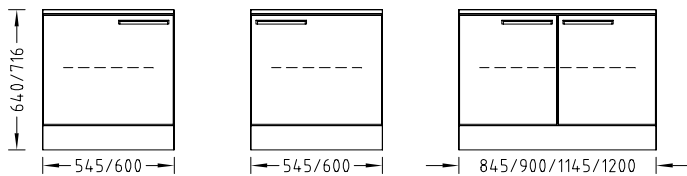

### Technical data

Dimensions						
Width [mm]	545	600	845	900	1145	1200
Depth [mm]	550					
Overall height [mm], push-in underbench unit for bench-mounted fume cupboards with rear panel installation	640					
Overall height [mm], push-in underbench unit for bench-mounted fume cupboards with side installation	716					
Height, plinth [mm]	110					

Load bearing capacity	
Per shelf [kg]	30

Design characteristics	
Construction	Hinged doors with 270° hinges Closed at the top, rear panel can be removed Shelf, height-adjustable 4 height-adjustable feet
Combination possibilities	See variants
Handle	Handle bar <i>SCALA</i> U handle, stainless steel
Full-height drawers	Optional
Extract air spigot	Optional
Underbench exhaust	Optional
Closing	Optional

## Underbench units

### Underbench unit for sinks

#### Intended use

- As an underbench unit for sinks for storing equipment and chemicals in acc. with EN 14727
- Not suitable for storing flammable liquids, gas cylinders and self-igniting or self-decomposing substances
- Not suitable for storing acids and alkalis

#### Design

Sink with underbench unit for service spines or wall benches

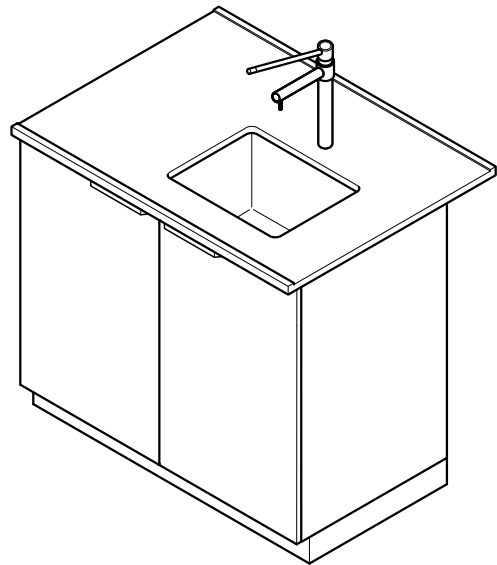

End sink for double benches

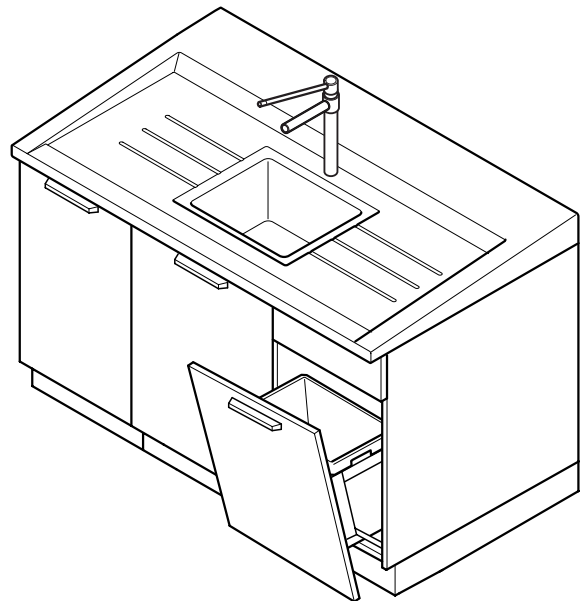

# Underbench units

## Underbench unit for sinks

### Variants

#### Sink with underbench unit for service spines or wall benches

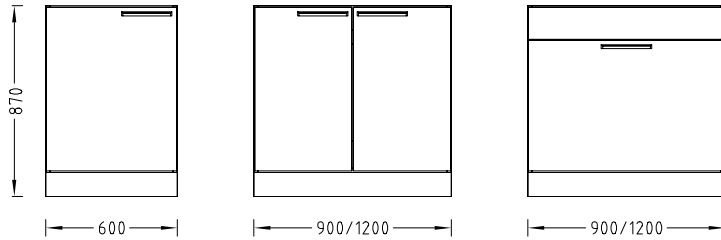

#### End sink for double benches

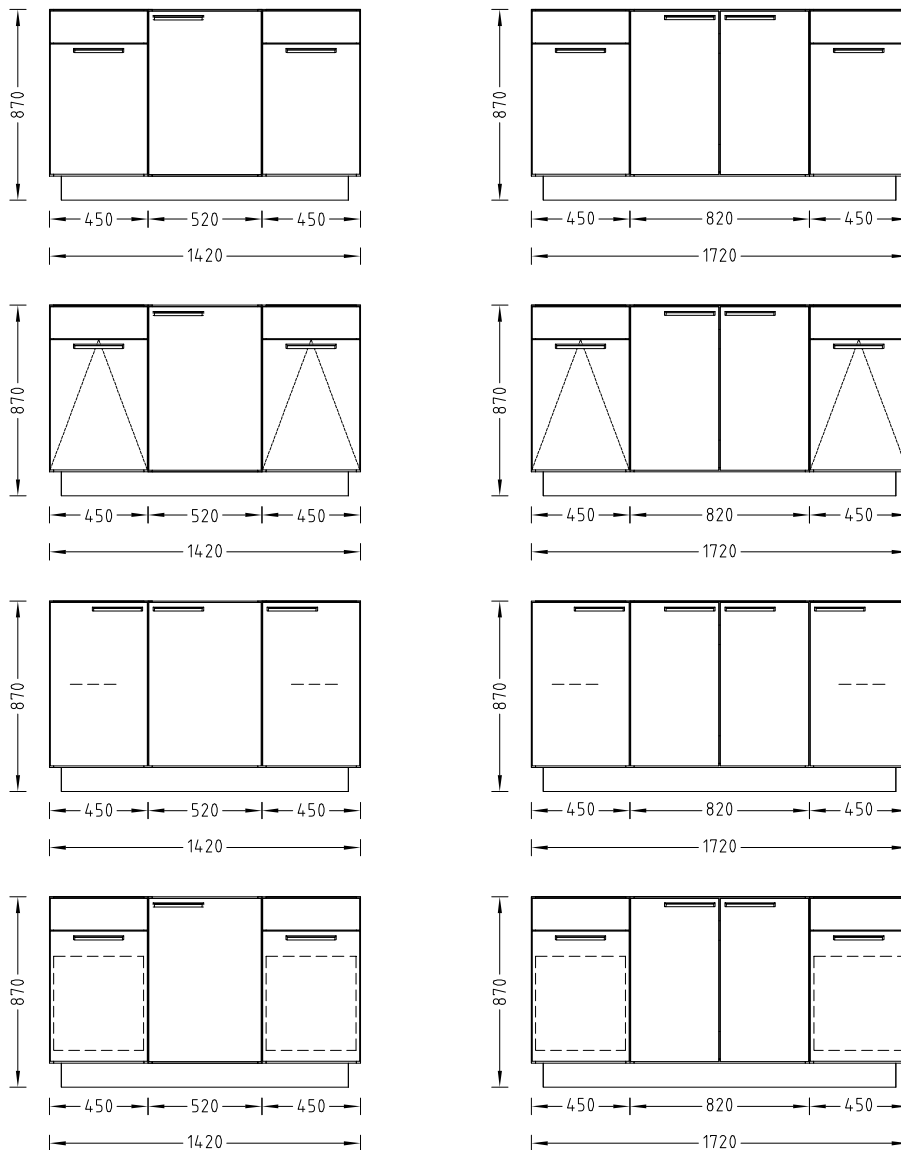

## Underbench units

### Underbench unit for sinks

#### Technical data

Dimensions					
Width [mm]	600 <sup>1)</sup>	900 <sup>1)</sup>	1200 <sup>1)</sup>	1420 <sup>2)</sup>	1720 <sup>2)</sup>
Depth [mm]	550			700	
Overall height [mm]	870				
Height, plinth [mm]	110				

<sup>1)</sup> For sinks on service spines or wall benches

<sup>2)</sup> For end sinks

Load bearing capacity	
Per shelf/drawer [kg]	30

Design characteristics	
Construction	Hinged doors with 270° hinges 4 height-adjustable feet Inclined swivel door with waste bin 30 l Waste bin 2 x 15 l with full-height drawer Waste bin 2 x 35 l with full-height drawer Hinged door(s), full-height drawer Combination possibilities see variants
Handle	Handle bar SCALA U handle, stainless steel
Closing	Optional